



Lake Mills Area  
SCHOOL DISTRICT

# Facilities Referendum 2024

After 14 months of community feedback, the Lake Mills Area School District Board of Education voted unanimously to present residents with two questions to address our highest-priority facility needs.



## Question #1

### District-wide Facility Improvements

**\$36.9M - NO TAX INCREASE\***

above the current tax rate for debt

- Address high-priority safety, security, site, and capital maintenance needs at all schools
- Reconfigure outdated learning spaces and special education areas at high school
- Renovate space for Science, Technology, Engineering & Math (STEM) programming, site safety, and health services at middle school
- Provide classroom space for early learning programming at the elementary school

## Question #2

### Lower HS Gym Replacement/Expansion

**\$14.3M - Maximum \$2/YR TAX INCREASE\***

for every \$100,000 of property value

- Replace small lower-level gym at the high school with a new, larger gym for school and community use

\* *The District is paying off past debt which allows the District to incur new debt with minimal impact to your tax rate.*

**Thank you, community!**

Your input helped create this solution.



**42 community members**

participated in **14-month Collaborative Advisory Team** (meetings/tours/presentations/prioritization/discussion/feedback)



**25% of community shared feedback**

through community facilities survey (review/feedback/direction)



**60% of residents**

support pursuing a referendum according to the community survey

## Understanding the Cost

### Maximum Referendum Tax Impact

Due to current lower interest rates, the tax impact could be lower.

Property Value	Question #1	Question #2
	<b>\$36.9 million</b> NO TAX INCREASE* above the current tax rate	<b>\$14.3 million</b> \$0.02 per \$1,000 of property value starting in Dec. 2024
	Per Year	Per Year
\$100,000	\$0	\$2
\$200,000	\$0	\$4
\$300,000	\$0	\$6

Financial estimates provided by Robert W. Baird & Co. are planning estimates only. Visit our website for more details about the financing plan and assumptions.

### Tax Rate Impact Compared to Previous Years

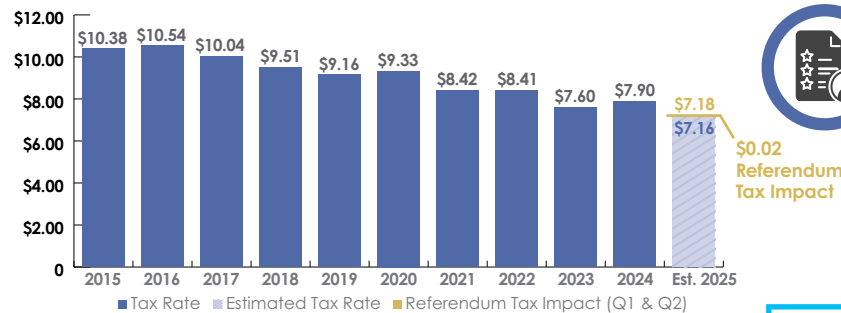

Source: Department of Public Instruction Note: Significant changes in market conditions, equalized property value, state aid or other factors can result in property tax changes.

**Learn More** [www.lakemills.k12.wi.us/district/facilities-referendum-2024.cfm](http://www.lakemills.k12.wi.us/district/facilities-referendum-2024.cfm)



Scan the QR code to visit our website.

# Project Details - Preliminary and Conceptual Site Plans

## Question #1

**District-wide Facility Improvements \$36.9M - NO TAX INCREASE\*** above the current tax rate for debt

Elementary School

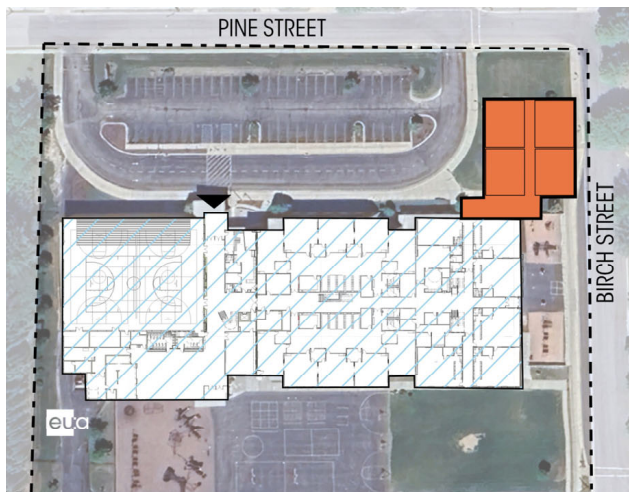

Middle School

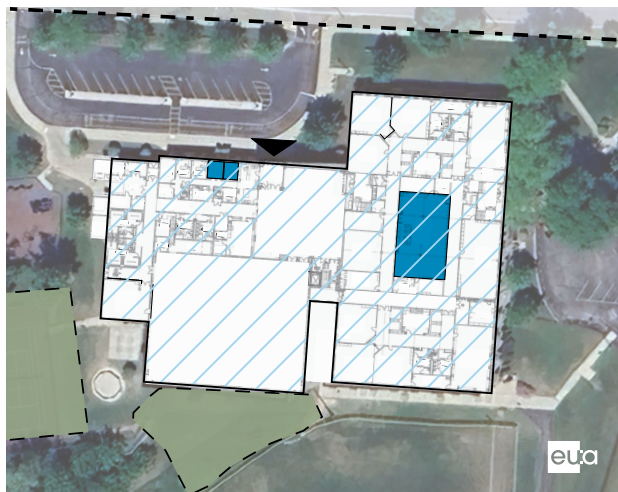

High School

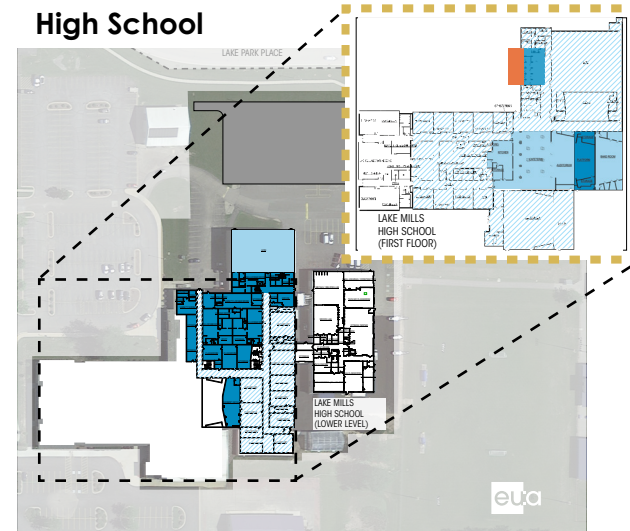

## Question #2

**Lower HS Gym Replacement/Expansion \$14.3M - Maximum \$2/YR TAX INCREASE\*** for every \$100,000 of property value

High School

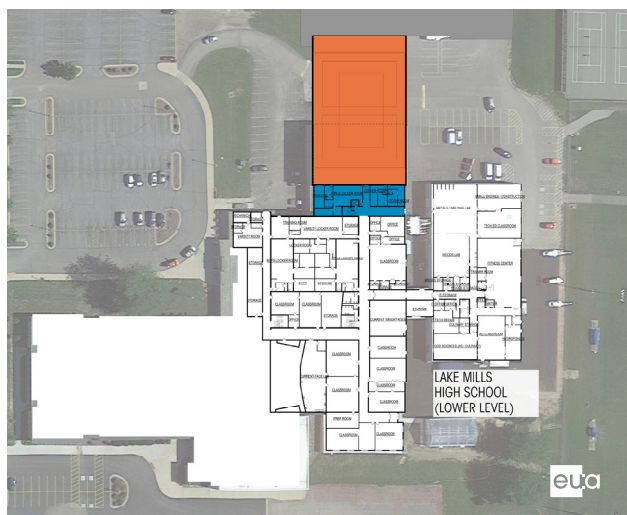

### KEY

- Capital Maintenance
- Light Renovation
- Heavy Renovation
- New Construction

\* *The District is paying off past debt which allows the District to incur new debt with minimal impact to your tax rate.*

## Contact

District Administrator Tonya Olson  
tonya.olson@lakemills.k12.wi.us or 920.648.2215



Scan the QR code  
to visit our website.